



FEATURES

- ▷ Working Pressure : 5kg/cm²
- ▷ Max Temperature : 80℃
- ▷ Ball : Full bore
- ▷ Material : ASTM A351 - CF8(1.4308)
ASTM A351 - CF8M(1.4408)
- ▷ End connection : Ferrule(clamp)
- ▷ ISO5211 Direct mounting pad
- ▷ Investment casting body & end cap

OPTION

- ▷ Fire safe design

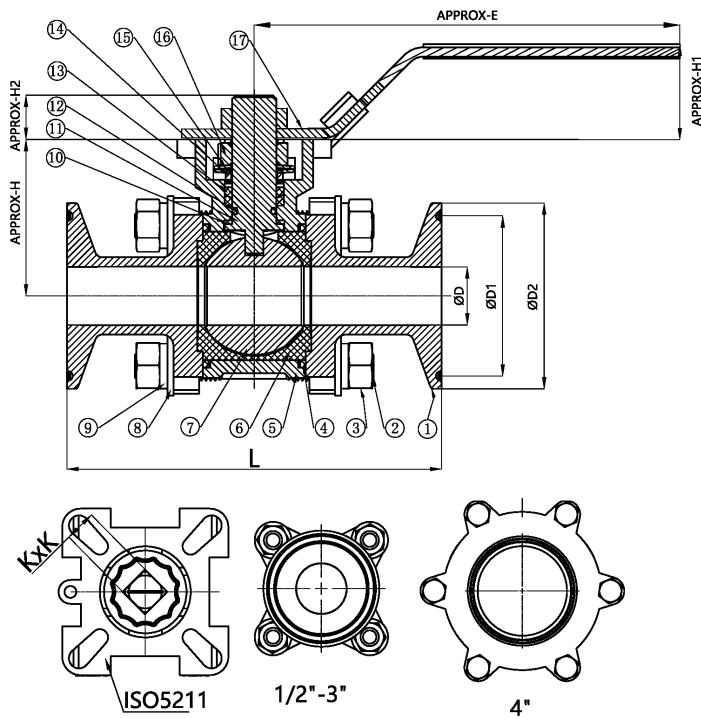

NO	PARTS NAME	METERIAL
1	CAP	SUS 304
2	BOLT	SUS 304
3	NUT	SUS 304
4	SEAL	PTFE
5	BODY	CF8/CF8M
6	SEAT	PTFE
7	BALL	SUS 304
8	WASHER	SUS 304
9	SPRING WASHER	SUS 304
10	STEM PACKING	PTFE
11	STEM	SUS 304
12	O RING	EPDN
13	PACKING	PTFE
14	PACKING GLAND	CF8
15	SPRING	SUS 304
16	NUT	SUS 304
17	HANDLE	SUS 304

SIZE		ISO-5211	D±0.5	L±1.5%	H	D1	D2	H1	H2	E
mm	INCH									
15	1/2"	F03-F04	9.4	89	64	43.6	25.2	28	9	131
25	1"	F04-F05	22.1	114	92	43.6	50.5	39.5	11	170
40	1-1/2"	F05-F07	34.8	125	118	43.6	50.5	45.5	14	215
50	2"	F05-F07	47.5	150	123	56.3	64	43.5	14	215
65	2-1/2"	F07-F10	60.2	197	138	70.6	77.5	43	14	215
80	3"	F07-F10	72.9	229	155	83.3	91	44.5	17	325
100	4"	F07-F10	97.4	241	173	110.3	119	50.5	22	325

품질향상을 위하여 사전 예고없이 사양이 변경 될 수 있습니다.